



# Chicago Miniature Lighting, LLC

*Lighting the world since 1910*

B-6 Single Bayonet Base & B-3 1/2 Single Contact Miniature Flange Base

## B-6 Single Bayonet Base

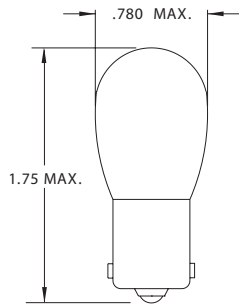

| Part Number | Design Voltage | Amps | MSCP | Life Hours | Filament Type | Comments    |
|-------------|----------------|------|------|------------|---------------|-------------|
| CM1317      | 6.0            | .45  | 3.4  | 100        | C-6           |             |
| CM209       | 6.5            | 1.78 | 15.0 | 100        | C-6           |             |
| CM105       | 12.8           | 1.00 | 12.0 | 500        | C-6           |             |
| CM1003      | 12.8           | .94  | 15.0 | 100        | C-6           |             |
| CM601-1     | 28.0           | .56  | -    | 2,000      | CC-81         | Blk. Bonnet |
| CM1308      | 28.0           | .56  | 16.0 | 2,000      | CC-81         |             |
| CM1309      | 28.0           | .52  | 15.0 | 300        | 2C-2R         |             |

## B-3 1/2 Single Contact Miniature Flange Base

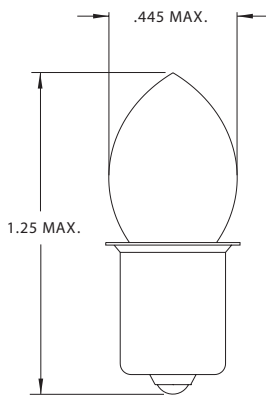

| Part Number | Design Voltage | Amps | MSCP | Life Hours | Filament Type | Comments        |
|-------------|----------------|------|------|------------|---------------|-----------------|
| PR8         | 1.90           | .60  | .65  | 10         | C-2R          |                 |
| PR1         | 2.00           | .95  | 1.00 | 40         | C-2R          |                 |
| PR28        | 2.20           | .80  | .90  | 20         | C-6           |                 |
| PR4         | 2.33           | .27  | .40  | 10         | C-2R          |                 |
| PR5         | 2.35           | .35  | .45  | 35         | C-2R          |                 |
| PR2         | 2.38           | .50  | .80  | 15         | C-2R          |                 |
| KPR102      | 2.40           | .70  | 1.30 | 15         | C-2R          | Kryton Gas Fill |
| KPR131      | 2.40           | .84  | 1.47 | 15         | C-2R          | Kryton Gas Fill |
| PR6         | 2.47           | .30  | .45  | 30         | C-2R          |                 |
| PR9         | 2.70           | .15  | .25  | 45         | C-2R          |                 |
| CM395X      | 3.00           | .07  | .15  | 50         | S-2           |                 |
| PR3         | 3.57           | .50  | 1.50 | 15         | C-2R          |                 |
| KPR103      | 3.60           | .70  | 2.70 | 15         | C-2R          | Kryton Gas Fill |
| PR29        | 3.60           | .20  | .60  | 30         | C-2R          |                 |
| PR7         | 3.70           | .30  | .90  | 30         | C-2R          |                 |
| PR30        | 3.75           | .86  | 2.25 | 40         | C-2R          |                 |
| PR13        | 4.75           | .50  | 2.00 | 15         | C-2R          |                 |
| KPR113      | 4.80           | .70  | 4.06 | 15         | C-2R          | Kryton Gas Fill |
| PR15        | 4.82           | .50  | 2.00 | 30         | C-2R          |                 |
| PR17        | 4.90           | .30  | 1.20 | 30         | C-2R          |                 |
| PR12        | 5.95           | .50  | 3.00 | 15         | C-2R          |                 |
| KPR118      | 7.20           | .55  | 5.23 | 15         | C-2R          | Kryton Gas Fill |
| PR18        | 7.20           | .55  | 4.20 | 20         | C-2R          |                 |
| PR20        | 8.63           | .50  | 5.00 | 15         | C-2R          |                 |
| PR16        | 12.50          | .25  | 2.70 | 50         | C-2R          |                 |

147 Central Avenue  
Hackensack, NJ 07601  
Phone: (201) 489-8989  
Fax: (201) 489-6911

18703 Dix Toledo Road  
Brownstown, MI 48193

Saret Zone Franca, Edificio B  
Alajuela Costa Rica

E-mail: sales@chml.com • Web Site: www.chml.com

Chicago Miniature Lighting, LLC reserves the right to make specification revisions that enhance the design and/or performance of the product