

UNCONTROLLED DOCUMENT

PART NUMBER IFL-LX906		REV. A
REV.	E.C.N. NUMBER AND REVISION COMMENTS	DATE
A	E.C.N. #11148.	772

ELECTRO-OPTICAL SPECIFICATIONS

DESIGN VOLTAGE:	13 V
OPERATING CURRENT:	0.89 AMPS @13V
INTENSITY:	61.0 MSCP
OPERATING LIFE:	1000 HRS @13VAC
BASE TYPE:	ALL GLASS WEDGE

MECHANICAL SPECIFICATIONS

BULB SIZE AND SHAPE:	T 15 TUBULAR
BULB GLASS TYPE:	KH 395
BASE OR LEAD FINISH:	NI FINISH
FLAMELET SHAPE:	C-2F
L.C.L. F APPLICABLE:	20.6mm
MANUFACTURING PPS:	112 Kc 488

ENVIRONMENTAL SPECIFICATIONS

VIBRATION TESTING:	ML-E-5400N, GRAFH IV
SHOCK TEST :	ML-STD-883 METHOD 2002 TEST CON A
OPERATING TEMPERATURE:	-55 TO +100 °C
STORAGE TEMPERATURE:	-55 TO +100 °C
SOLDERABILITY OF LEADS:	NOT APPLICABLE

NOTES:

- LAMP TO BE ARGON FILLED.
- LAMP TO BE MARKED WITH VOLTAGE AND WATTAGE ONLY.

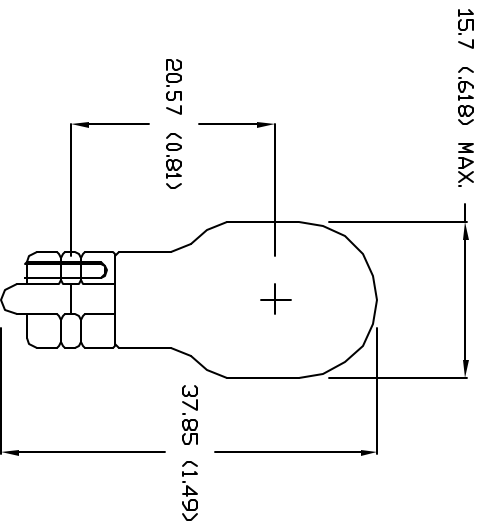

UNLESS OTHERWISE SPECIFIED TOLERANCES PER ASME, PRECISION AND X-41 (MILS), X3-41.5 (MILS), X3-41.5 (MILS), X30-41.12 (MILS), LEAD SIZE-T15 (MILS), LEAD LENGTH-T15 (MILS), MIN. TUBULAR PRESSION MAX. TUBULAR PRESSION

REV. A	PART NUMBER IFL-LX906	CONSTRUCTION INFORMATION THE INFORMATION CONTAINED IN THIS DOCUMENT IS THE PROPERTY OF LUMEX INC. EXCEPT AS SPECIFICALLY AUTHORIZED IN WRITING BY LUMEX. NO PART OF THIS DOCUMENT IS TO BE REPRODUCED OR TRANSMITTED IN ANY FORM OR BY ANY MEANS, ELECTRONIC OR MECHANICAL, INCLUDING PHOTOCOPYING, RECORDING, OR BY ANY INFORMATION STORAGE AND RETRIEVAL SYSTEM. LUMEX INC. SHALL PROTECT SUCH RIGHTS IN THIS DOCUMENT AND SHALL PROTECT SUCH RIGHTS IN THIS DOCUMENT AND SHALL PROTECT SUCH RIGHTS IN THIS DOCUMENT.
T-15mm ANSI NO. 906, INCANDESCENT LAMP, ALL GLASS WEDGE.		OUR MANY YEARS OF EXPERIENCE WITH MANUFACTURING MAKE THAT SOLDER JOINT IS A MAJOR CAUSE OF FAULTY AND EARLY FAILURE. PLEASE PAY ATTENTION TO YOUR SOLDERING PROCESS.

DRAWN BY: JC	CHECKED BY:	APPROVED BY:	DATE:
			8.21.85
			PAGE: 1 OF 1
			SCALE: N/A

UNCONTROLLED DOCUMENT

290 E. HELEN ROAD  
PALATINE, IL 60067-8978  
PHONE: +1.847.359.2790  
US WEB: www.lumex.com  
TW WEB: www.lumex.com.tw