

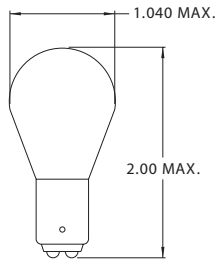

## S-8 Double Contact Bayonet Base



Part Number	Design Voltage	Amps	MSCP	Life Hours	Filament Type
CM1228	32.0	.45	15.0	150	C-2V
CM653	37.5	.83	32.0	500	C-2V
CM895	40.0	.53	14.0	3,800	C-13
CM1229	40.0	.38	15.0	400	C-2V
CM110	44.0	.17	6.0	200	C-7A
CM1676	45.5	.22	7.6	1,000	C-13

## S-8 Double Contact Index Base

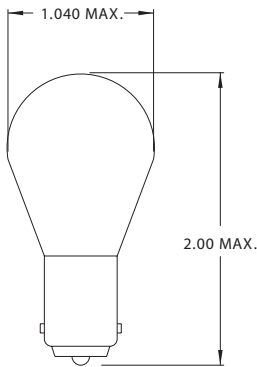

Part Number	Design Voltage	Amps	MSCP	Life Hours	Filament Type
CM1154	6.4	2.63	21.0	200	2C-6*
	7.0	.75	3.0	1,000	2C-6*
CM1606	6.4	2.69	21.0	200	C-6
CM1626	6.4	3.00	23.0	500	C-2R
CM198	12.8	2.25	32.0	1,200	C-6*
	14.0	.68	3.0	5,000	C-6*
CM1016	12.8	1.34	21.0	200	C-6*
	14.0	.59	6.0	1,000	C-6*
CM1034	12.8	1.80	32.0	200	C-6*
	14.0	.59	3.0	5,000	C-6*
CM1035	12.8	1.44	21.0	1,000	C-6*
	14.0	.59	3.0	5,000	C-6*
CM1157	12.8	2.10	32.0	600	C-6*
	14.0	.59	3.0	5,000	C-6*
CM2057	12.8	2.10	32.0	1,200	C-6*
	14.0	.48	2.0	5,000	C-6*
CM2357	12.8	2.23	40.0	400	C-6*
	14.0	.59	3.0	500	C-6*
CM1662	28.0	.93	32.0	400	CC-6*
	28.0	.94	6.0	1,000	C-2V*

\* Dual Filament Lamp

## S-11 Single Contact Bayonet Base

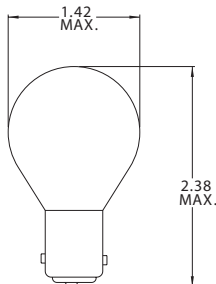

Part Number	Design Voltage	Amps	MSCP	Life Hours	Filament Type
CM1723	6.2	4.50	32.0	400	C-6
CM309	28.0	.90	32.0	300	C-2V
CM311	28.0	1.29	50.0	300	C-2V
CM3011	28.0	1.29	44.0	1,000	C-2V

147 Central Avenue  
Hackensack, NJ 07601  
Phone: (201) 489-8989  
Fax: (201) 489-6911

18703 Dix Toledo Road  
Brownstown, MI 48193

Saret Zone Franca, Edificio B  
Alajuela Costa Rica

E-mail: sales@chml.com • Web Site: www.chml.com